

## Technical Specifications (Short Version)

Thanks for bringing your show to Nairn and *The Little Theatre*.

This provides a basic overview of the facilities at the Theatre, our full technical specification can be found at <https://nairnlittletheatre.org.uk/technical>

### Auditorium

70 seats theatre style on retractable seating / rostra (Rows A/B level with stage)

### Stage Dimensions

<b>Stage Width (Excl SL Wing)</b>	7.3m	<b>Stage Depth (Full)</b>	5.1m
		<b>Stage Depth (To Screen)</b>	4.1m
<b>Proscenium Width</b>	5.6m	<b>Proscenium Height</b>	3.2m
<b>SL Wing Width</b>	1.7-2.7m	<b>SR Wing Width</b>	1m
<b>Dock Door Width</b>	1.54m	<b>Dock Door Height</b>	2.1m
<b>Grid Height</b>	5.6m	<b>LX Bar Height</b>	4m

### Drapes & Masking

<b>U/S Blacks</b> operated from SL Wing	<b>Fixed Mids</b> (Black) operated from SL wing
<b>Red House Tabs</b> operated from SL Wing	<b>Blk S/Tooth Gauze</b> (Olio Drop) op from SR
<b>Three legs</b> SL and SR	

### Lighting

<b>Positions</b>	3x Fixed IWBs on Stage 1x Fixed Bar on Stage (non IWB) 1x FOH Advance Bar IWB 2x FOH Side IWBs	6x Dips on US Wall (3x SL/3x SR)
<b>Control</b>	ETC Element 40 Classic (Eos 3.2) 24 Channels of Dimming* (36 on request)	250 Channels, 1,024 Attribute
<b>Fixtures</b>	22x S4 Jr (12x 26°, 10x 25-50°) 4x Strand SL 6x Selecon Rama 2x Selecon Acclaim F (Tab Warmers) 6x PAR64 (No Par-Safe) 12x Selecon Hui (3x 4 Cell Battens) 9x ETC Source Four PAR	4x ADJ LP200ST COB Cannon (RGBAL LED Wash Lights) 8x Prolights Stark 400 LED* 3x Clay Paky Alpha Spot 800* 2x Martin Mac250 Krypton (NB Non-Standard Gobos)
<b>Effects / Atmos</b>	UV Cannons, Strobe, Hazer, Smoke, and Low Fog available	

**\*NB** The Prolights STARK 400, and Clay Paky Units are not owned by the theatre and may not be available. please contact us in advance if you are reliant on these or a similar moving head unit. Additional hire charge applies for use of the Clay Paky Alpha Spot units due to the operational cost.



## House Audio

<b>Control</b>	Soundcraft Si Compact Digital Mixer	
<b>Speakers</b>	2x Turbosound Inspire iP1000	2x JBL Control One Pro (Monitors)
<b>Multi</b>	12x (8x Available) XLR Tie Lines (6x Send, 2x Return)	
<b>Playout</b>	Mac Mini (w/ QLab 4)	
<b>Microphones</b>	4x Sennheiser ew300 G2 Beltpack 2x Sennheiser ew300 G2 Handheld 2x Behringer C-2 1x Behringer C-1	2x Sennheiser e845 Handheld 1x Sennheiser e614 2x Audio-Technica PRO45 Hanging 2x PULSE MP33868 (Show Relay)

## Comms

4x Metro Audio / Tecpro compatible belt packs and headsets  
Alternatively, there are 3x Wireless DECT headsets.

**Please note at this time these systems are mutually exclusive and not interlinked**

## Projection

**Backdrops** The Theatre is equipped with a 'digital backdrop' arrangement. An Optoma EH320UST ultra short through projector is permanently hung downstage of LX 3 and produces an image of 5.5m x 3.8m. The screen is motorised but **cannot be moved during performance**

**Video** There is an additional 5000 lumen video projector designed for video screening purposes available.

## Power

**Max Capacity** 3ø 200A Incomer

**Stage Power** Numerous 13A outlets provided throughout the stage and auditorium, protected by 30mA RCDs.

2x 32A 1Ø SL at stage level, **must be used with additional distribution with 30mA RCDs for sockets or final circuits.**

## Accommodation

<b>Dressing Room 1</b>	2.2x3.2m	<b>Dressing Room 2</b>	2.6x3.3m
------------------------	----------	------------------------	----------

Each of the above can accommodate 4-5, partition between can be removed to form one room

<b>Dressing Room 3*</b>	5.1x4.5	(*this area is not a dedicated dressing room but can be used as such by arrangement)
-------------------------	---------	--

Backstage paging and show relay (audio and video) to all dressing rooms

Private cast/Crew WC located in DR corridor

## House Information

### Accessibility

There is a platform lift to the rear row (H) of the auditorium, and step-free access to Row A for wheelchair users can be facilitated – please note this is by way of escorting patrons via the dressing room corridor.

### Box Office

Ticket sales through our box office are **online only** and on the door.  
No in-person box office service at present.  
50p per ticket booking fee will be applied to all sales.

### Merchandising

Merchandise can be sold from a table in the foyer by prior arrangement.

### Catering

No kitchen facilities, small servery area FOH with Tea/Coffee making facilities.  
Bar can be provided by arrangement (Occasional License required)

### Staffing

*The Little Theatre* is operated by a charity, Nairn Drama, and staffed by volunteers. We will endeavour to help in any way, but please keep in mind that the theatre is not permanently staffed nor has predefined opening hours and there is no on-site office.

We ask that visiting companies provide two people to assist Front of House where possible, but can fulfil this from our own team of volunteers if required.

We will discuss your staffing requirements and can provide trained sound, lighting, and stage management personnel from our own team or trusted external contractors if required.

Additional charges may apply for staffing.

### Parking / Vehicle Access

The Theatre has no dedicated parking and limited on-street parking locally in a residential area, We ask that you are considerate to our neighbours and local residents and move all vehicles to the nearby (350yd) Links Car Park when not required at the Theatre.

Loading doors direct to stage available

### Health and Safety

Building users must familiarise themselves with our Health and Safety Policy.  
All Risk Assessments must be supplied no later than 14 days prior to the first agreed date of hire.

**NB** The use of any effects beyond standard haze - such as pyrotechnics, smoke, or strobe lighting - **must be approved prior to use** and may be subject to restrictions.

## Contact and More Information

If you have any further questions about *The Little Theatre* and our facilities please don't hesitate to get in touch.

Please keep in mind that we are a charity and staffed by volunteers, as such we can't guarantee to answer the phone or keep 'normal office hours' (although we will be there when you need us!)

You can call eMail [tech@nairnlittletheatre.org.uk](mailto:tech@nairnlittletheatre.org.uk) with any general enquiries.

During your production you will be given the details of the Duty Manager who will assist you with anything in the Theatre.

# Floor Plan (Ground Level)

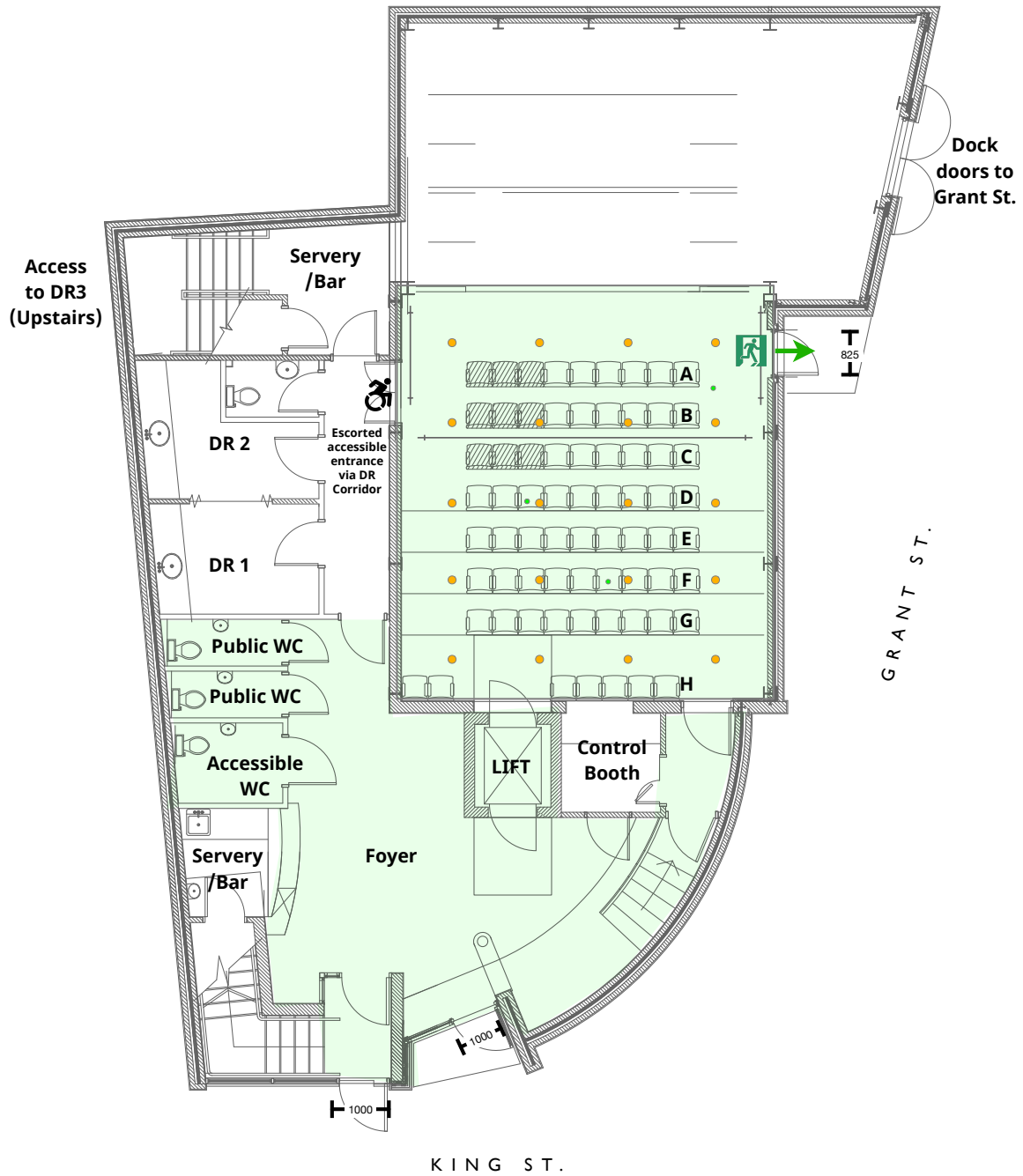

# LX Circuit Plan

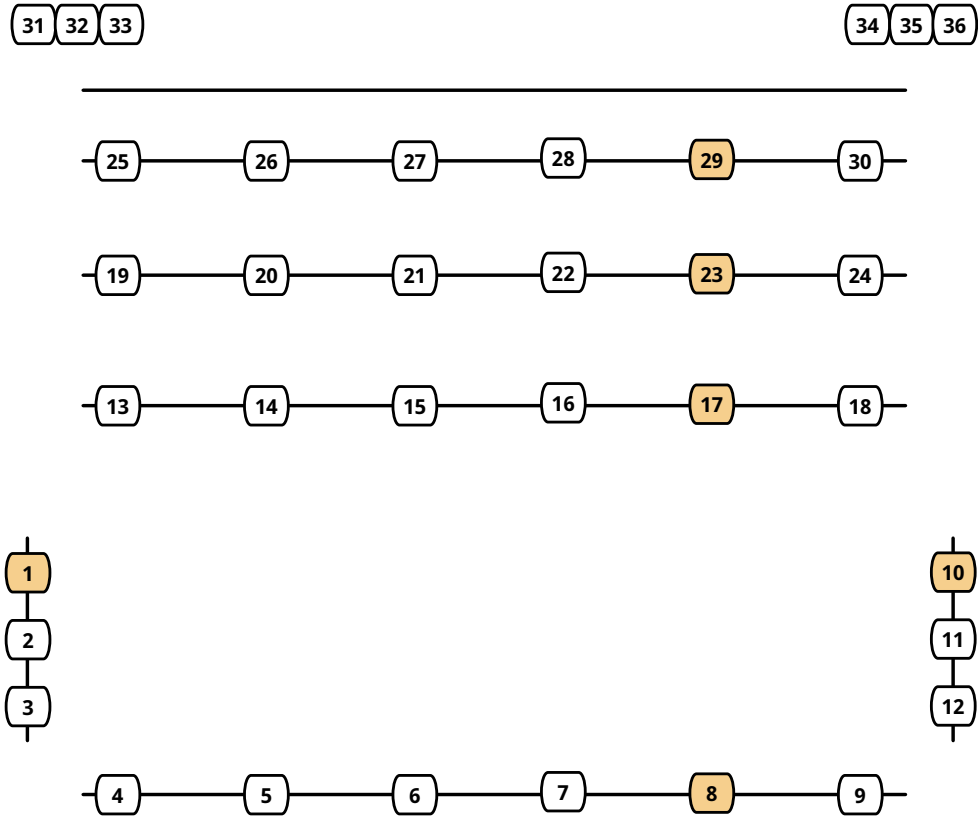

**CAUTION**  
MORE THAN ONE PHASE MAY  
BE PRESENT ON EACH BAR

**TAKE CARE TO IDENTIFY CIRCUITS WITH LED OR  
INTELLIGENT FIXTURES. DO NOT CONNECT LED OR  
INTELLIGENT FIXTURES TO DIMMER POWER**

The outlets highlighted in **Amber** are typically patched to provide hard power to intelligent and LED fixtures, and are not generally available for patching to dimmers.

All LX circuits are terminated to BS 546 15A outlets and are limited to a **maximum of 10A** (2300W) per outlet (whether hard power or dimmed), please take care to ensure that this limit is not exceeded.

For guidance, this limit is approx. equivalent to; 2x PAR64, 2x Fresnels, 4x S4 Jr / S4 Par

Outlets are patchable however the house dimmers are fixed to DMX channels **1-24**  
House Lights are on DMX channels **501-506** and cannot be rematched.

Where possible we ask that you do not disturb the house rig, but you are free to re-patch (or unpatch) it as required

# LX House Rig

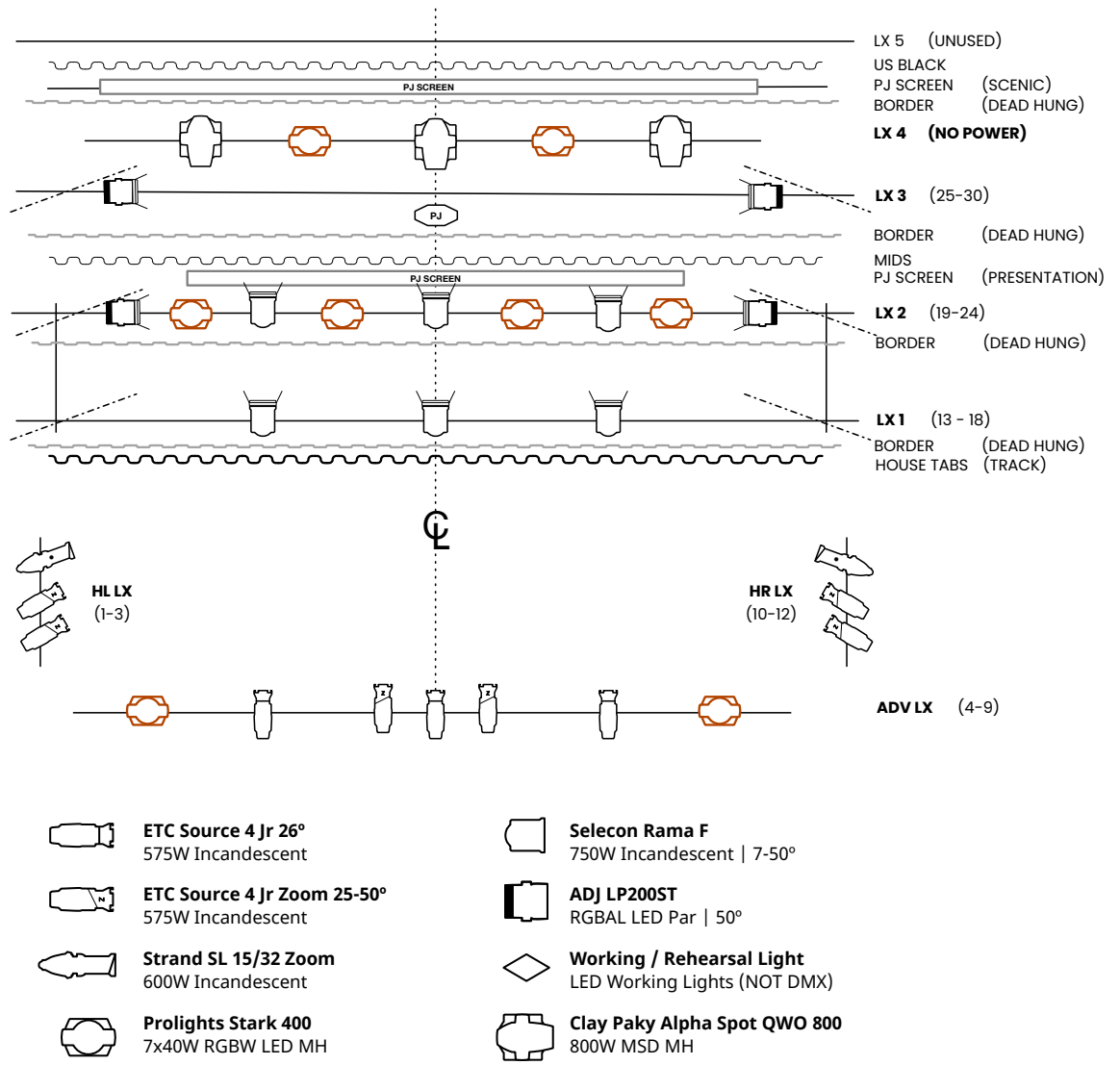

The standard house rig provides lighting for most visiting and basic productions without much change. Where possible we ask that you do not disturb the house rig, but you are free to re-patch (or unpatch) it as required

The fixtures highlighted in **Amber** are not owned by The Little Theatre but are typically available for use.

Our lighting control is an ETC Element running EOS 3.2. There is a free offline editor, ETCnomad, available from [etconnect.com](http://etconnect.com). We can send you the current basic show file for the house rig as required on request.