

Technical Specifications (Short Version)

Thanks for bringing your show to Nairn and *The Little Theatre*.

This provides a basic overview of the facilities at the Theatre, our full technical specification can be found at <https://nairnlittletheatre.org.uk/technical>

Auditorium

70 seats theatre style on retractable seating / rostra (Rows A/B level with stage)

Although retractable, the seating bank should be considered fixed except by prior arrangement. Additionally it is possible to remove only rows A/B which reduces the capacity to 52.

Stage Dimensions

Stage Width (Excl SL Wing)	7.3m	Stage Depth (Full)	5.1m
		Stage Depth (To Screen)	4.1m
Proscenium Width	5.6m	Proscenium Height	3.2m
SL Wing Width	1.7-2.7m	SR Wing Width	1m
Dock Door Width	1.54m	Dock Door Height	2.1m
Grid Height	5.6m	LX Bar Height	4m

Drapes and Masking

U/S Blacks operated from SL Wing	Fixed Mids (Black) operated from SL wing
Red House Tabs operated from SL Wing	Blk S/Tooth Gauze (Olio Drop) op from SR
Three legs SL and SR	Fixed Borders (Black Serge)

Flying

There are two lightweight (WLL 30kg) fly bars mid stage. However, please note that there is restricted height and we do not have a fly tower, as such tall set pieces / cloths cannot be flown so that they are hidden from view. Spot lines can be facilitated

The cleat rail is located at stage level in the SR wing,

Scenic Notes

All scenery must be free standing and constructed using standard methods and **must** be fire retardant in accordance with ABTT Code of Practice. A small stock of stage weights are available, but we recommend you bring sufficient for your own scenery.

The upstage projection screen can be used effectively as a cyclorama, and appropriate cyc wash lights are hung to facilitate this.



Lighting

The theatre benefitted extensively from an upgrade to LED lighting in early 2024.

The new LED lighting rig has been designed to accommodate most shows in a space of our size without the need to change it, the inclusion of moving heads allow most specials to be achieved without hanging additional fixtures.

We have a small stock of additional lanterns for specials that can be hung as required, and you're welcome to bring your own, **but we would ask that the fixed house fixtures are not moved or refocussed except by prior arrangement**, subject to other users' requirements around the time of your performance.

Positions	3x Fixed IWBs on Stage (15A and True1) 1x Fixed Bar on Stage (non IWB) 1x FOH Advance Bar IWB 2x FOH Side IWBs	6x Dips on US Wall (15A) (3x SL/3x SR)
Control	ETC Element 40 (Eos 3.x) 18 Channels of Dimming	250 Channels, 1,024 Attribute
Fixtures	3x eLumen8 Virtuoso 600 RGBAL Profile 5x eLumen8 Virtuoso 600 RGBAL Profile # 6x eLumen8 Virtuoso 2000F RGBAL # 3x eLumen8 Virtuoso 700 CYC RGBALC # 8x Cameo ROOT PAR 6 RGBAW+UV # 4x ADJ LP200ST RGBAL #	3x Elation Fuze Spot # 2x Elation Fuze Profile # 4x S4 Jr (26° Fixed) 6x S4 Jr Zoom (25-50°)
	Fixtures marked with a # above form part of the house rig and cannot ordinarily be repositioned or refocussed.	
Effects / Atmos	Xenon Strobe, Hazer, Smoke, and Low Fog available. Additional hire charges may apply.	

The Little Theatre has a relationship with local hire companies and can source a number of moving heads. LED, and other specialist effects upon request, just let us know what you need and we'll be happy to help

The latest lighting plan, including channel listings and an ETC Eos show file can be found at <https://nairnlittletheatre.org.uk/tech> or eMail tech@nairnlittletheatre.org.uk



House Audio

Control	Soundcraft Si Compact Digital Mixer	
Speakers	2x Turbosound Inspire iP1000	2x JBL Control One Pro (Monitors)
Multi	12x (8x Typically Available) XLR Tie Lines (6x Send, 2x Return)	
Playout	Mac Mini (w/ QLab 4)	
Microphones	4x Sennheiser ew300 G2 Beltpack 2x Sennheiser ew300 G2 Handheld	2x Sennheiser e845 Handheld 1x Sennheiser e614 2x Audio-Technica PRO45 Hanging 2x PULSE MP33868 (Show Relay)

Comms

4x Metro Audio / Tecpro compatible belt packs and headsets
Alternatively, there are 3x Wireless DECT headsets.

Please note at this time these systems are mutually exclusive and not interlinked

Projection

Backdrops The Theatre is equipped with a 'digital backdrop' arrangement. A 4000 lm Optoma EH320UST ultra short throw projector is permanently hung downstage of LX 3 and produces an image of 5.5m x 3.8m. The screen is motorised but **cannot be moved during performance**. This screen can also be used as a cyclorama effectively.

Video / Cinema There is an additional 5750/6500 lumen Digital Projection e-Vision 6900 that can be used for screening video. This is permanently mounted downstage of the prosc. on the auditorium ceiling and **cannot be moved**.

Power

Max Capacity 3ø 200A Incomer

Stage Power Numerous 13A outlets provided throughout the stage and auditorium, protected by 30mA RCDs. Hard power available on all IWBs on True1 Outlets

2x 32A 1Ø SL at stage level, **must be used with additional distribution with 30mA RCDs for sockets or final circuits.**

Accommodation

Dressing Room 1	2.2x3.2m	Dressing Room 2	2.6x3.3m
------------------------	----------	------------------------	----------

Each of the above can accommodate 4-5, partition between can be removed to form one room

Dressing Room 3*	5.1x4.5	(*this area is not a dedicated dressing room but can be used as such by arrangement)
-------------------------	---------	--

Backstage paging and show relay (audio and video) to all dressing rooms

Private Cast/Company WC located in DR corridor

House Information

Accessibility

There is a platform lift to the rear row (H) of the auditorium, and step-free access to Row A for wheelchair users can be facilitated – please note this is by way of escorting patrons via the dressing room corridor.

Box Office

Ticket sales through our box office are **online only** and on the door.
No in-person box office service at present. A booking fee will be applied to all sales.

Merchandising

Merchandise can be sold from a table in the foyer by prior arrangement.

Catering

No kitchen facilities, small servery area FOH with Tea/Coffee making facilities.
Bar can be provided by arrangement (Occasional License required)

Staffing

The Little Theatre is operated by a charity, Nairn Drama, and staffed by volunteers. We will endeavour to help in any way, but please keep in mind that the theatre is not permanently staffed nor has predefined opening hours and there is no on-site office.

We ask that visiting companies provide two people to assist Front of House where possible, but can fulfil this from our own team of volunteers if required.

We will discuss your staffing requirements and can provide trained sound, lighting, and stage management from our own team or trusted external contractors if required.

Additional charges may apply for staffing.

Parking / Vehicle Access

The Theatre has no dedicated parking and limited on-street parking locally in a residential area, We ask that you are considerate to our neighbours and local residents and move all vehicles to the nearby (350yd) Public Links Car Park when not required at the Theatre. Please also take care to reduce noise as much as possible when loading/unloading.

**No loading / unloading may take place before 0800
or after 2300 except by prior arrangement.**

Loading doors direct to stage available.

There is public EV charging located at the Community and Arts Centre (22kW Type 2) and at Court House Lane Car Park (50kW CCS) both around 400 yards from the theatre.

Health and Safety

Building users must familiarise themselves with our Health and Safety Policy. All Risk Assessments must be supplied no later than 14 days prior to the first agreed date of hire.

Construction and strike of set must follow our Set Construction Guidelines and be erected and struck without excessive noise due to our residential location (use of power tools to assemble / strike set is strictly limited to domestic-type drill-drivers or similar)

NB The use of any effects beyond standard haze - such as smoke, or strobe lighting - **must be approved prior to use** and may be subject to restrictions.

The use of pyrotechnics is strictly prohibited



Contact and More Information

If you have any further questions about *The Little Theatre* and our facilities please don't hesitate to get in touch.

Please keep in mind that we are a charity and staffed by volunteers, as such we can't guarantee to answer the phone or keep 'normal office hours' (although we will be there when you need us!)

You can call eMail tech@nairnlittletheatre.org.uk with any general enquiries.

During your production you will be given the details of the Duty Manager who will assist you with anything in the Theatre.

Floor Plan (Ground Level)

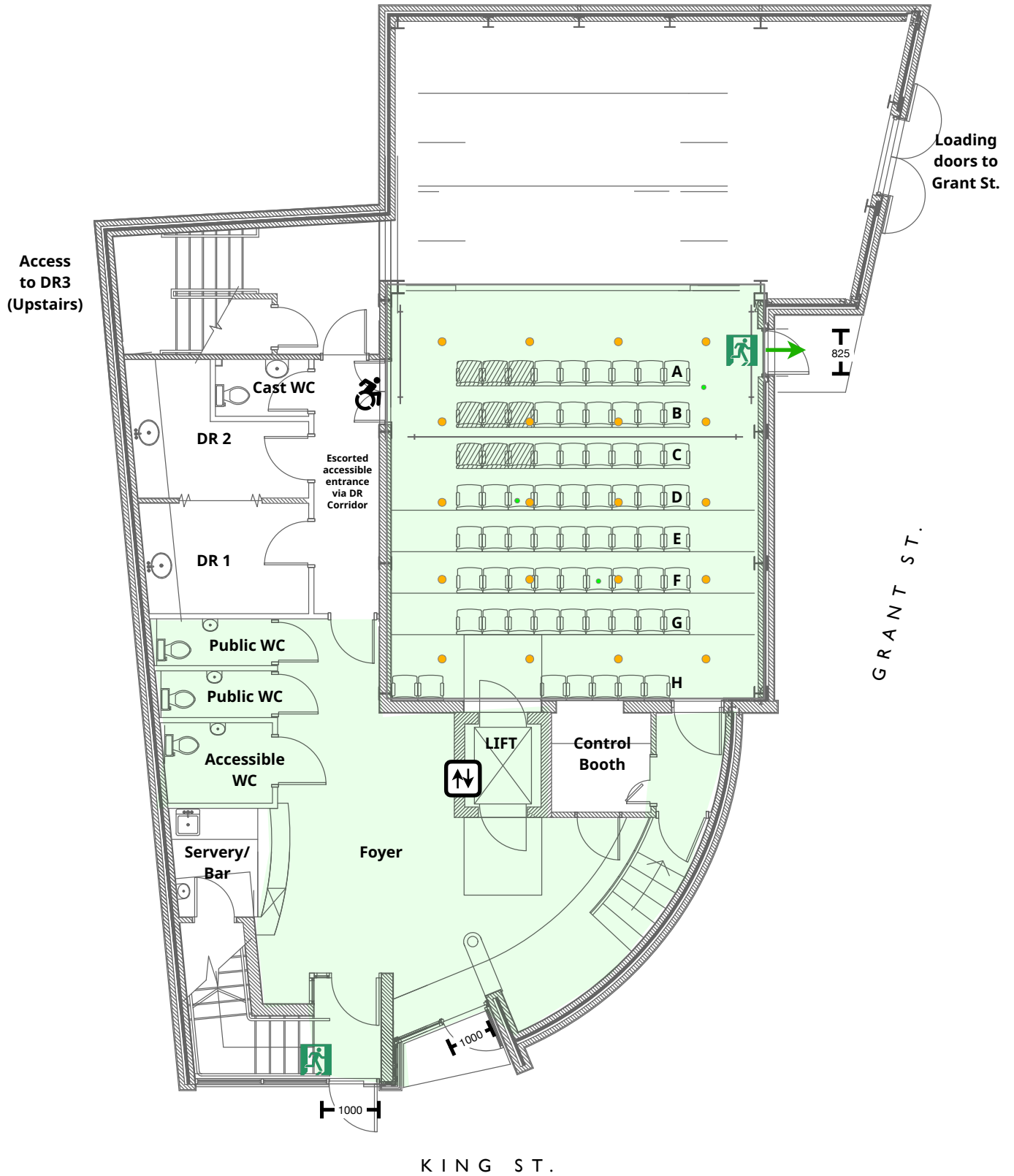



LX Circuits and Patch

Each on stage bar has 4x BS 546 15A outlets which can be patched to 18x 10A dimmers and 2x Neutrik True1 connections which provide hard power to LED / intelligent fixtures

DMX is available on each bar. We have a mixture of 5pin and 3pin DMX fixtures and a small mixed cable stock. Please do not rely on us having enough DMX cable if you bring or hire additional fixtures.

LX House Rig

We operate a Standard Lighting Rig as shown overleaf.

This has been designed to accommodate most performances with minimal refocussing or repositioning of fixtures and enables *The Little Theatre* to host many performances with minimal effort as well as ad-hoc use by local groups.

Where possible we ask that you do not refocus or move any of these lanterns but rather hang additional fixtures if required.

Our lighting control is an ETC Element running EOS 3.x. There is a free offline editor, ETCnomad, available from etconnect.com. A basic show file with (approximate) August3d model can be found at <https://nairnlittletheatre.org.uk/tech>

The fixtures used are configured as shown below

Fixture	Colour Mix	Mode	DMX Footprint	Performance Notes
Virtuoso 2000 F	RGBAL	TR-16 Tour (16 Bit)	19	Studio Mode
Virtuoso 600 Profile	RGBAL	TR-16 Tour (16 Bit)	18	Studio Mode
Virtuoso 700 CYC	RGBALC	TR-16 Tour (16 Bit)	20	Studio Mode
Cameo Root Par 6	RGBAW+UV	12ch Delay Off	11	No Barndoors
ADJ COB LP200ST	RGBAL	20ch	20	50°
Elation Fuze Spot	RGBMA	Extended	41	
Elation Fuze Profile	RGBMA	Extended	59	

The in-house fixtures must NOT be readdressed or have modes changed